

OPTION-1
ON - ROAD JOINT BAY (DUAL DIRECTION CABLE INSTALLATION)
 Scale 1:500

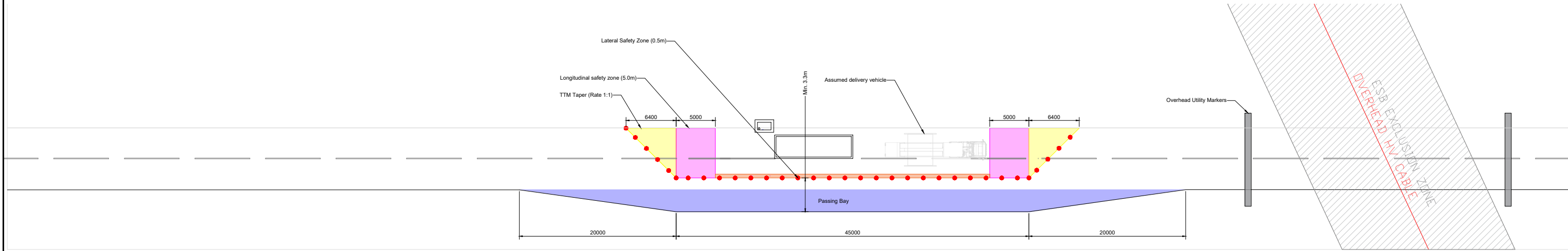

OPTION-2
ON - ROAD JOINT BAY (SINGLE DIRECTION CABLE INSTALLATION)
 Scale 1:500

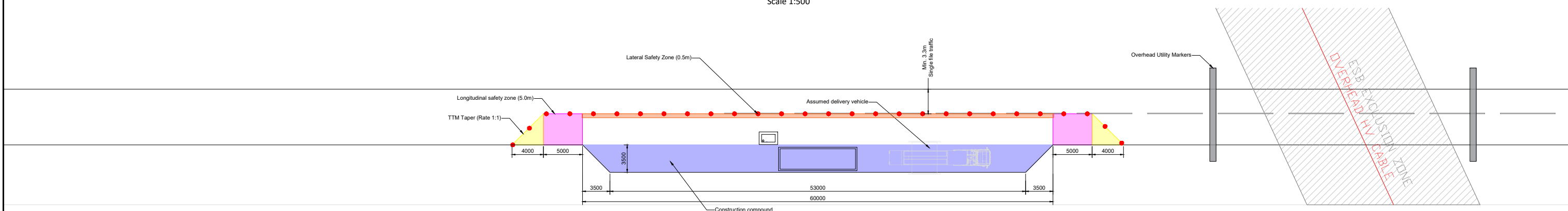

OFF - ROAD JOINT BAY
 Scale 1:500

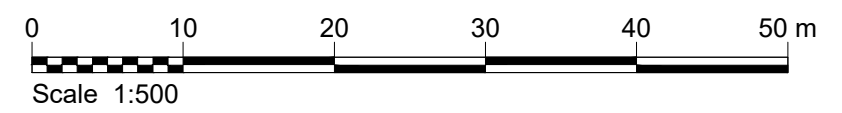

Rev	Rev. Date	Purpose of revision	Orig	Check'd	Rev'd	Appr'd
P02	30/01/24	Issued for Planning	OS	DH		GS
P01	18/08/23	Issued for Planning	OS	DH		GS

NOTES

- FOR PLANNING PURPOSES ONLY. NOT FOR CONSTRUCTION.
- ALL DIMENSIONS ARE IN MILLIMETRES UNLESS OTHERWISE NOTED.
- WHERE LEVELS ARE SHOWN, ALL LEVELS ARE IN METRES ABOVE MALIN HEAD DATUM.
- THE LOCATIONS OF THE FOLLOWING ARE ILLUSTRATED INDICATIVELY; JOINT BAYS, TELECOMMUNICATIONS CHAMBERS, LINK BOXES, PASSING BAYS, HORIZONTAL DIRECTIONAL DRILLING AREAS AND LAYDOWN AREAS. FINAL LOCATIONS AND LAYOUT ARE SUBJECT TO DETAILED DESIGN.

REFERENCE DRAWINGS

32108AJ-JAC-ZZ-XX-DR-Z-2101 to Site Location Map Sheets 1 to 47
 32108AJ-JAC-ZZ-XX-DR-Z-2147

LEGEND

- LONGITUDINAL SAFETY ZONE (5.0 M)
- TTM TAPER (RATE 1:1)
- PASSING BAY/CONSTRUCTION PLATFORM
- LATERAL SAFETY ZONE
- TRAFFIC MANAGEMENT - i.e. CONE

Jacobs
 Merion House, Merion Road, Dublin, D04R2C5, Ireland
 Phone: +353 (0)1 269 5666 Fax: +353 (0)1 269 5497
 www.jacobs.com

Client

EirGrid

Project
EAST MEATH NORTH DUBLIN GRID UPGRADE

Drawing title
JOINT BAY AND PASSING BAY ARRANGEMENTS PROPOSED DETAILS

Drawing status
Fit for Information

Suitability
S2

Scale
 1:500 @ A3

Jacobs No.
 321084AJ

Client No.
 CP1021

Drawing number
321084AJ-JAC-ZZ-XX-DR-C-0001

DO NOT SCALE

Rev
 P02

© Copyright 2024 Jacobs U.K. Limited. The concepts and information contained in this document are the property of Jacobs. Use or copying of this document in whole or in part without the written permission of Jacobs constitutes an infringement of copyright. Limitation: This drawing has been prepared on behalf of, and for the exclusive use of Jacobs' Client, and is subject to, and issued in accordance with, the provisions of the contract between Jacobs and the Client. Jacobs accepts no liability or responsibility whatsoever for, or in respect of, any use of, or reliance upon, this drawing by any third party.